

**LAVARDA**

**MOPED**

**48 cc. 2 cycle**

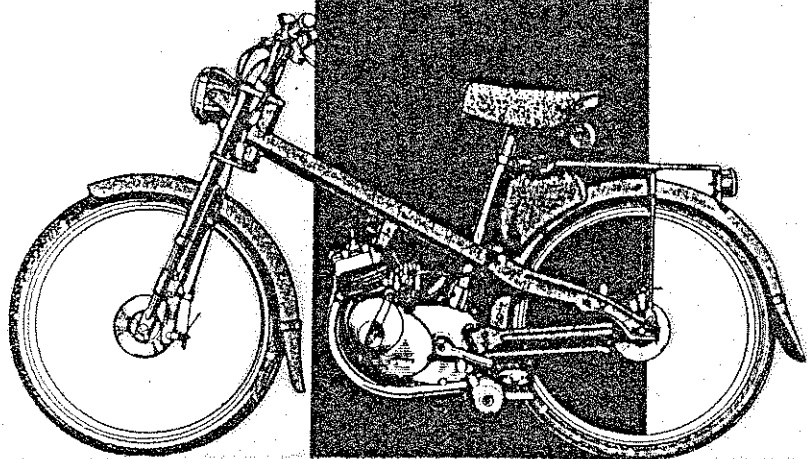

E Holes for greasing

A Starting lever

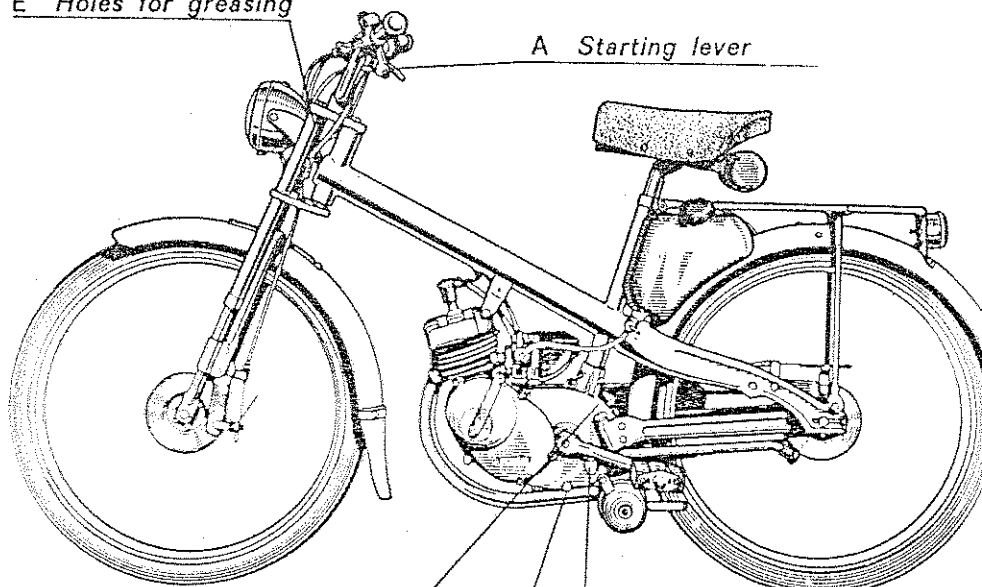

B Lever to engage pedals

C Oil filler cap

D Drain plug

**Brakes:**

Both wheels are equipped with disk brakes operated by independent hand-levers.

**Lighting:**

Lighting and signaling device as per regulations.

**Performance:**

Maximum speed: 40 kms per hour

**Weight:**

Empty weight: 32 kilos

**Fuel consumption:**

(C.U.N.A. Regulations): 1.5 liter/100 Kms

**STARTING THE ENGINE**

- 1) Make sure that the fuel tank contains enough gasoline
- 2) Make sure that Lever « B » (see illustration) is in the « M » position
- 3) Open the fuel tap and lower the little lever located on the carburator.
- 4) Ride the first few yards using the pedals.
- 5) After a few thrusts on the pedals turn the throttle gently to gain speed and pull the clutch lever « A ». Release the lever as soon as the engine starts.
- 6) Operate the twist-grip to accelerate progressively till the little lever situated on the carburator is fully released.
- 7) Should you occasionally wish to use your moped as an ordinary bicycle without using the engine, press lever « B » till it reaches position « P ».

While riding on very steep gradients, it is possible to help the engine by working the pedals.

Should the engine work be uneven or should the engine stop suddenly, proceed as follows:

- 1) Ensure that there is enough fuel in the tank and that the mixture can reach the carburator.
- 2) Inspect the sparking plug and clean it properly, if necessary.

In case the engine should not work after this simple operation, riders are advised to apply to the nearest mechanic and delegate the repair to him. Being extremely simple, the vehicle can be easily put in full working order.

## **MAINTENANCE**

Your moped has been so designed that only the minimum maintenance is required.

We would however recommend some simple operations which, if duly carried out from time to time, will certainly secure your motor-bicycle of an excellent performance and a long life.

The engine contains some oil that lubricates the transmission gear. When the running-in period is over, it will be necessary to change the oil. To perform this operation in the correct manner, unscrew the lower cap « D » when the engine is hot. Allow the oil to drain and position the cap again. Open the upper cap « C » and replenish with fresh oil up to the hole level. Use oil SHELL X 100 MOTOROIL SAE 40. Successive inspections may be limited to checking the oil level and to ensuring that same is always the highest. If necessary add some fresh oil and replace the whole quantity every 5000 kms.

From time to time it is advisable to lubricate the front fork inserting some grease through hole « E ».

## RUNNING-IN

During the first few miles riders are advised not to turn the throttle more than the first half of its full opening, thus not exceeding the speed of 25/30 Kms per hour.

The running-in period is over after a 10-liter fuel consumption.

During the early period of the machine's life, the owner is advised to avoid steep slopes, if possible, and not to stress the engine excessively.

Owing to the initial bedding-down process, many parts (brakes, clutch, screws and bolts) must be adjusted. Riders should perform this operation as soon as they judge it necessary.

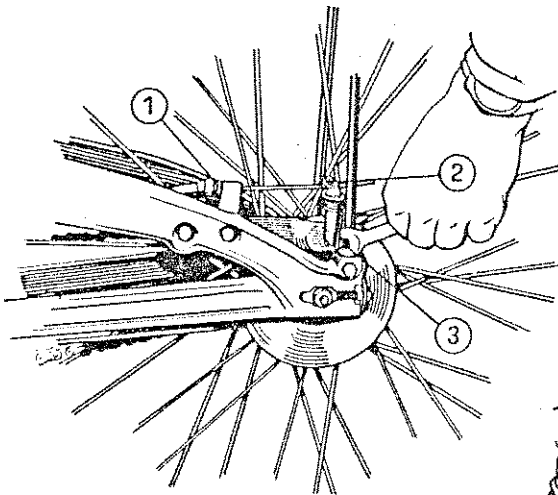

*Clutch adjustment*

①      ②

*Brake adjustment*

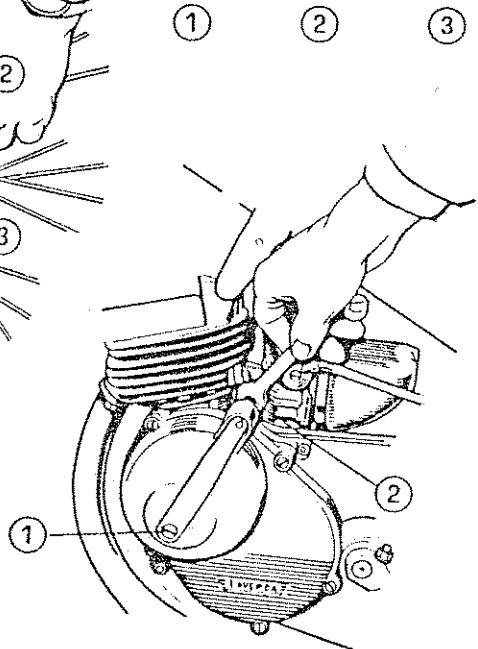

①      ②      ③

## TECHNICAL DATA

### ENGINE:

Special Cast Iron Single Cylinder - Two cycle Engine

Stroke: 38 mm

Total Piston Displacement: 47.8 cu cms

Compression Ratio: 1 : 6

Horse Power Output: 1.49 HP at 4200 r.p.m.

Feeding: petrol at 5 % It is recommended to use SAE OIL 30

Fuel tank capacity: 3 liters

Carburator: Dell'Orto Type SHA 14/12 with cold start device

Ignition: The ignition process is effected by a 6-volt 18-watt alternator flywheel with a contact-breaker incorporated

Platinum Points: distance 0.4 mm

Sparking Plug: W 240 T1 Bosch

Clutch: automatic clutch by centrifugal mass in oil bath:

### Transmission:

Gear transmission connecting engine with pedals

Chain transmission connecting pedals with rear wheel

### Frame:

Tubular frame with stamped plate rear fork.

Front wheel suspension by telescopic fork.

Wheels: front and rear rim 24 x 1 ¾

Tires: 24 x 1 ¾

## **spare parts list**

When ordering some spare parts, customers are kindly requested to specify the vehicle number impressed on the left member of the fork.

**Illustration 1 - CRANKCASE - CYLINDER - CYLINDER HEAD**

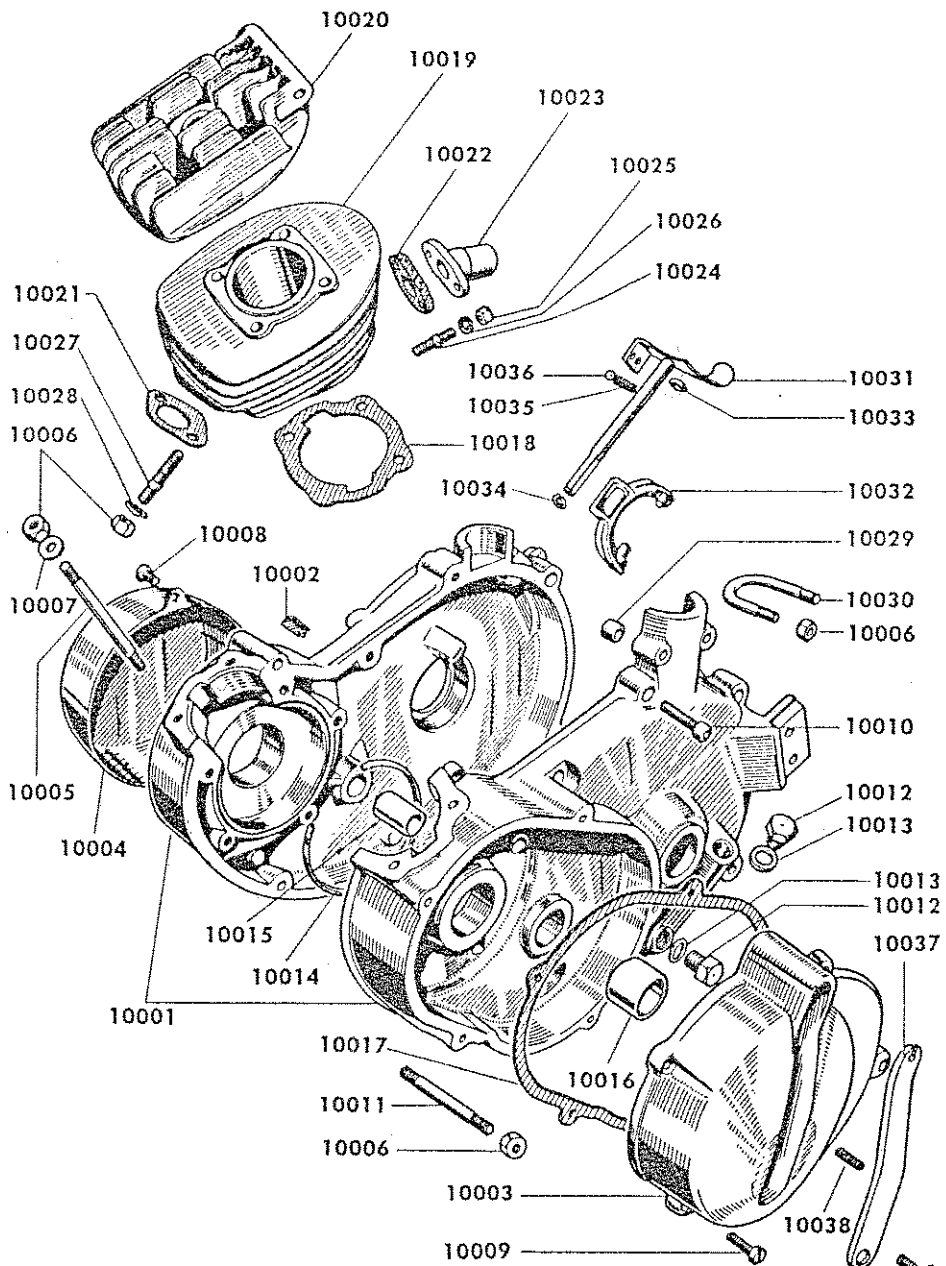



ENGINE - CLUTCH - PEDAL UNIT

Illustration 2

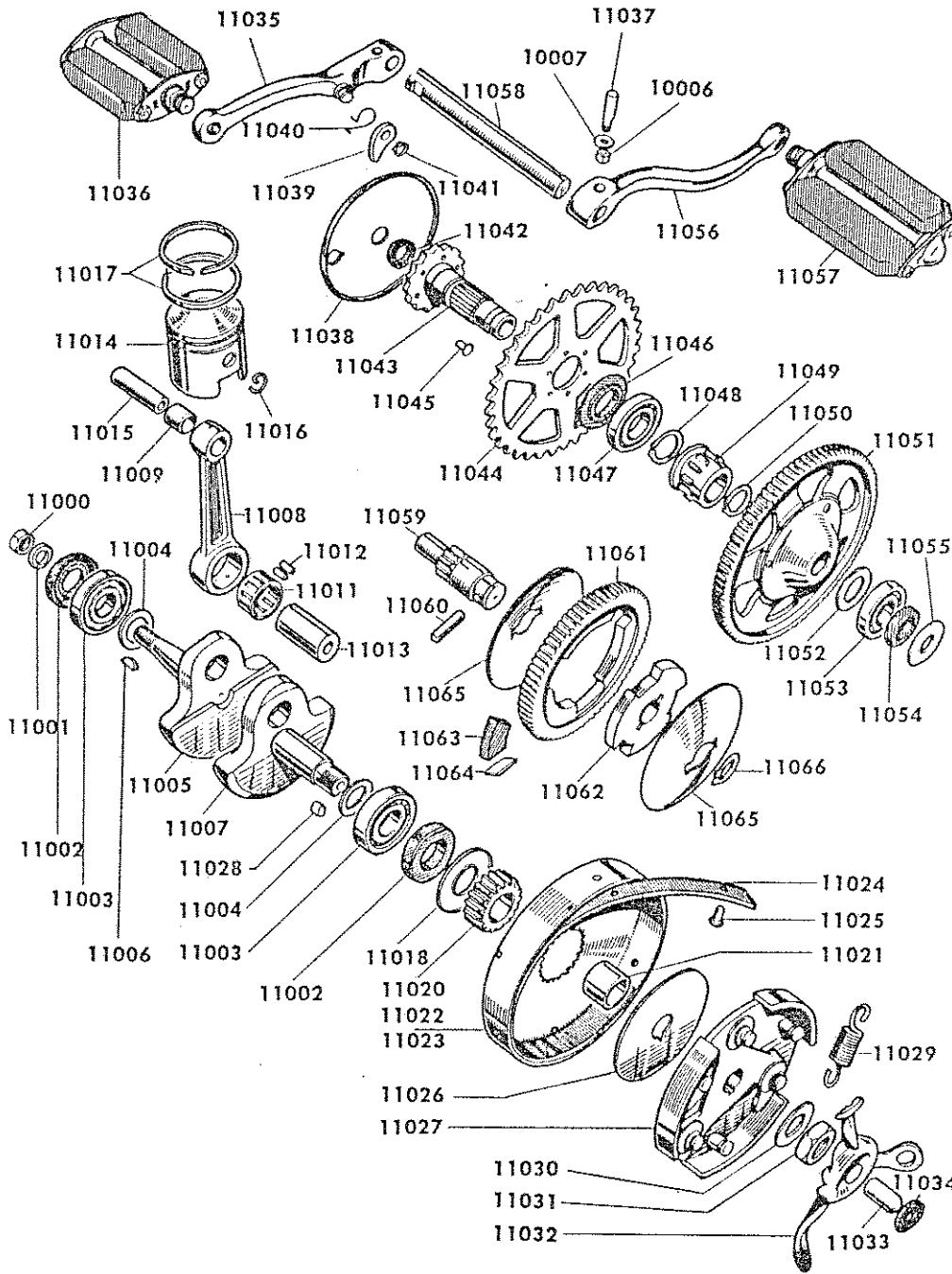

**Illustration 3 - FRAME - SADDLE - FENDER - TELESCOPIC FORK**

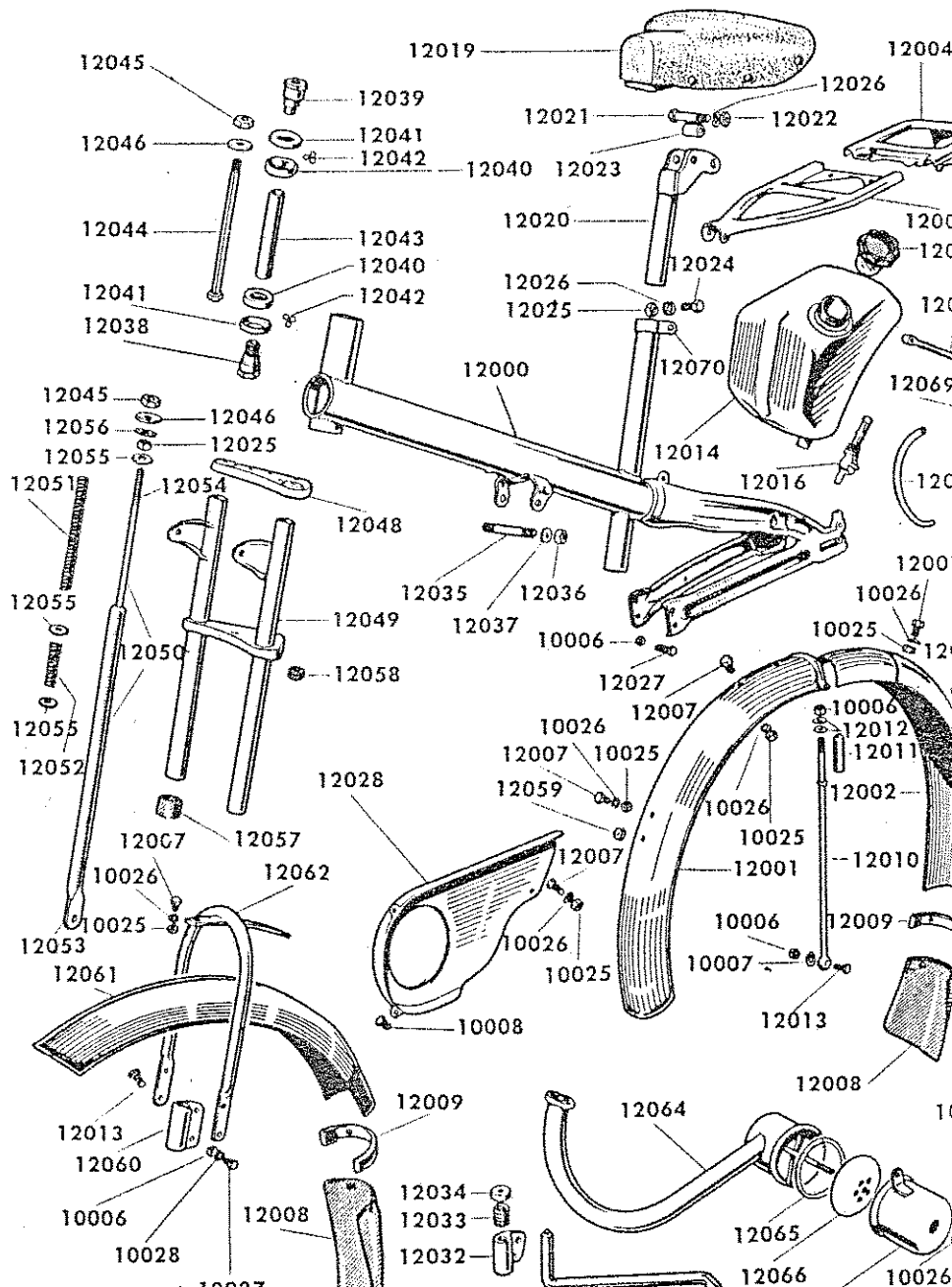

# WHEELS - HUBS - HANDLEBAR - CABLES Illustration

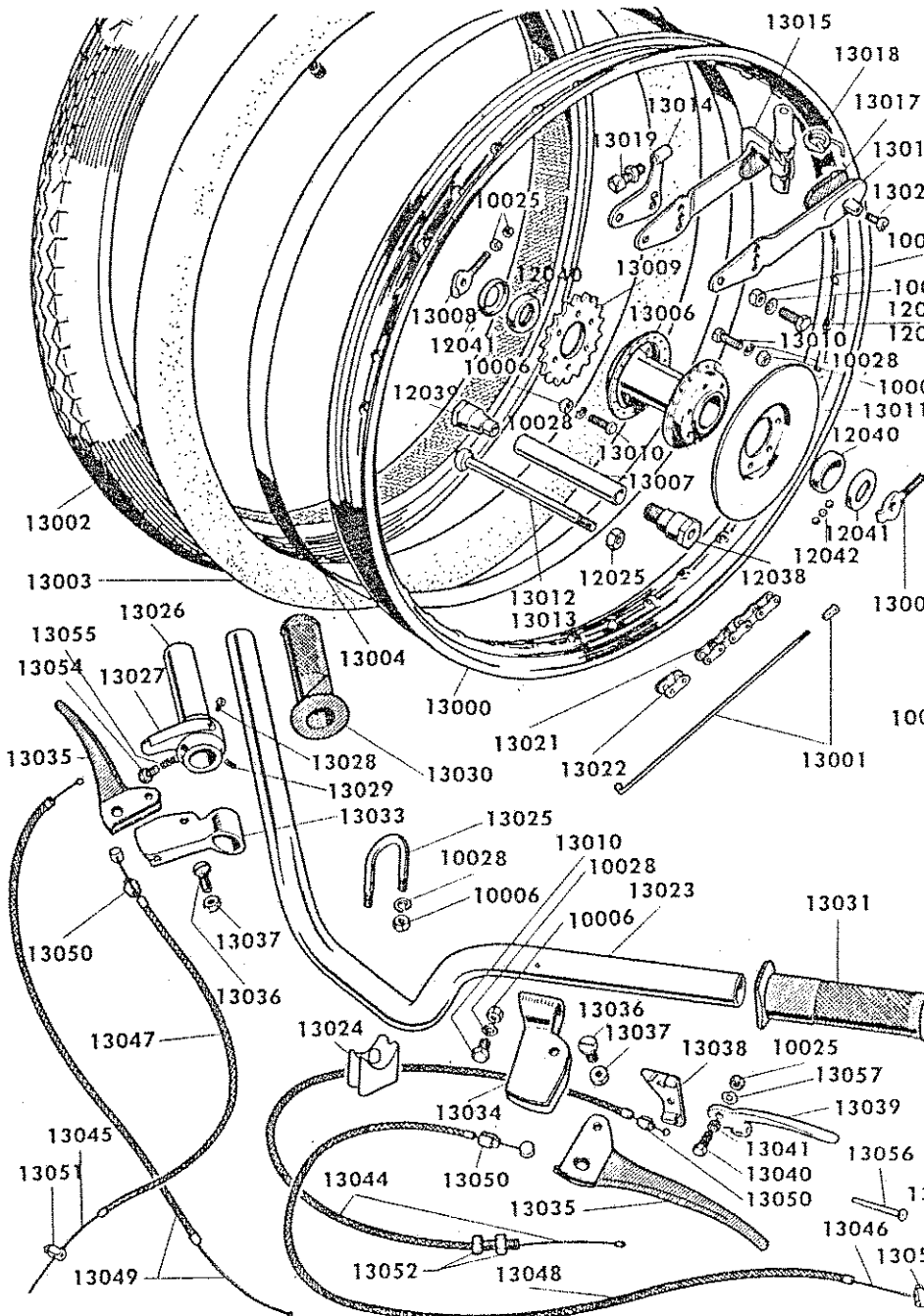
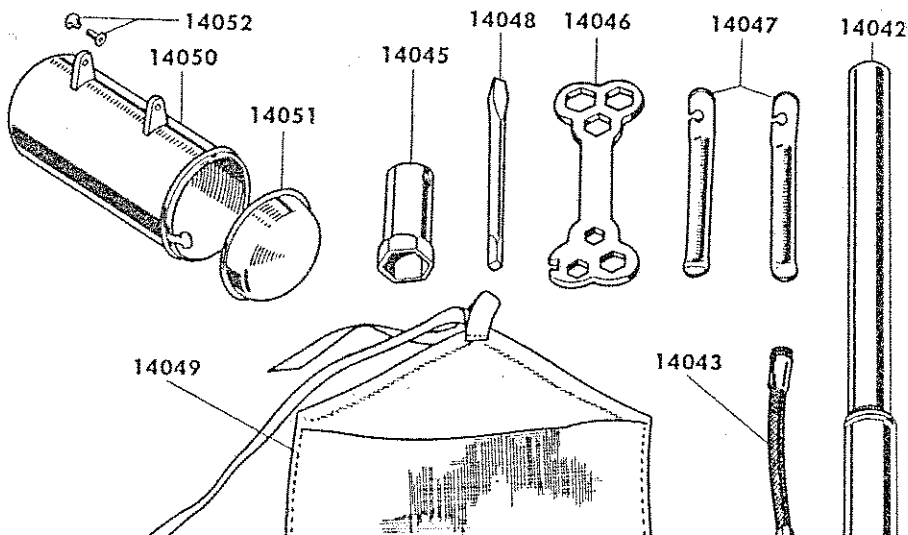
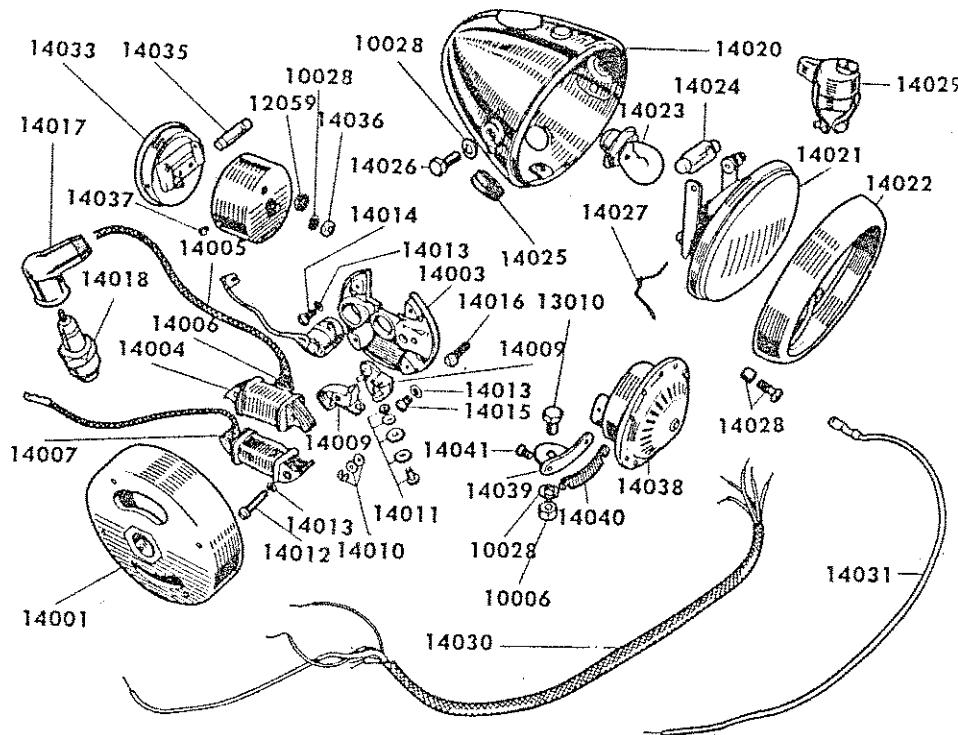

Illustration 5 -

**LIGHTING - TOOLKIT**



# CARBURATOR

Illustration 6

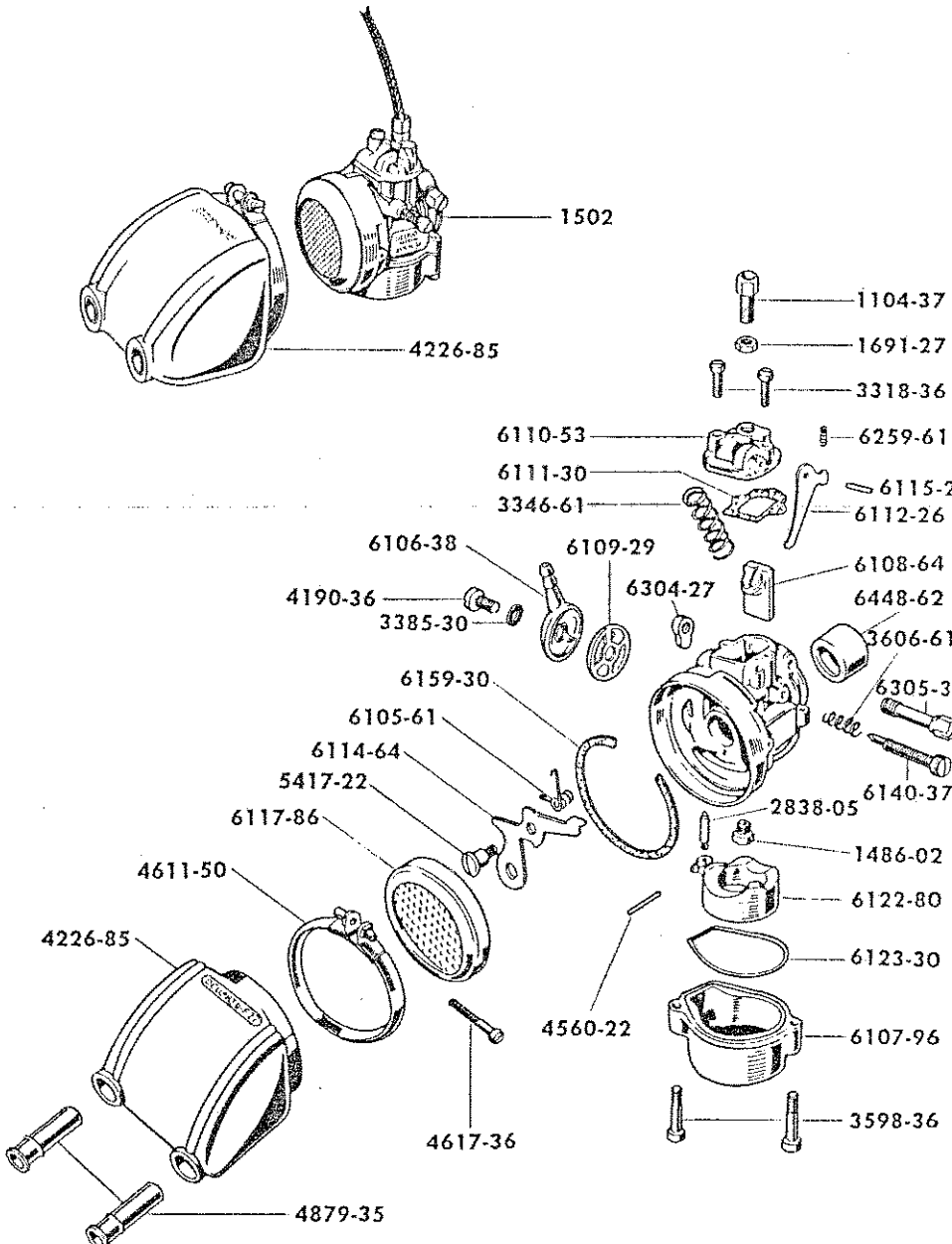

## Illustration 1 - CRANKCASE - CYLINDER - CYLINDER HEAD

10001	R.H. and L.H. Inner crankcase	10020	Cylinder head
10002	Rubber (for flywheel cables)	10021	Gasket (for exhaust pipe)
10003	L. H. Cover (on the clutch side)	10022	Gasket (for suction manifold)
10004	R. H. Cover (on the flywheel/magneto side)	10023	Suction manifold
10005	Stud (holding head and cylinder)	10024	Stud (retaining manifold)
10006	Nut	10025	Nut
10007	Washer	10026	Spring washer
10008	Screw (retaining flywheel cover and chain guard)	10027	Stud (retaining exhaust pipe)
10009	Screw (retaining clutch cover)	10028	Spring washer
10010	Screw (holding inner crankcase)	10029	Bush (centering crankcase)
10011	Stud (holding inner crankcase)	10030	Stud (retaining engine to saddle-holder)
10012	Drain plug	10031	Lever (operating pedal-unit clutch)
10013	Fiber washer	10032	Fork
10014	Crankcase circlip	10033	Gasket
10015	Bush for camshaft (flywheel side)	10034	Circlip
10016	Bush for camshaft (clutch side)	10035	Spring
10017	Gasket for cover (clutch side)	10036	Ball
10018	Gasket (for cylinder base)	10037	Clutch operating lever
10019	Cylinder	10038	Spring
		10039	Screw

## Illustration 2 - ENGINE - CLUTCH - PEDAL UNIT

11000	Nut (retaining flywheel)	11034	Oil seal
11001	Washer	11035	Pedal crank
11002	Oil seal	11036	R. H. Pedal
11003	Journal ball bearing	11037	Crank key
11004	Washer	11038	Plate disk
11005	Axle shaft (flywheel side)	11039	Pallet
11006	Woodruff key	11040	Spring
11007	Axle shaft (clutch side)	11041	Circlip
11008	Connecting rod with bush	11042	Oil seal
11009	Small end bush	11043	Freewheel bush
11010	Connecting rod cage (complete with rollers)	11044	Sprocket
11011	Connecting rod cage (without rollers)	11045	Rivet
11012	Roller	11046	Rubber washer
11013	Crankpin	11047	Ball bearing
11014	Piston (bare)	11048	Circlip locating ball bearing (25 mm)
11015	Gudgeon pin	11049	Bush coupling pedal unit
11016	Circlip (gudgeon pin fixing)	11050	22 mm. circlip
11017	Compression piston ring	11051	Pedal unit gear
11018	Washer	11052	Washer
11019	Complete clutch unit (gears and lining)	11053	Ball bearing
11020	Clutch driving pinion with bush	11054	Oil seal
11021	Bush (for clutch driving pinion)	11055	Washer
11022	Clutch cover (bare)	11056	L. H. pedal crank
11023	Clutch cover with lining	11057	L. H. pedal
11024	Friction facing	11058	Pedal unit shaft
11025	Rivet	11059	Shaft
11026	Clutch centrifugal washer	11060	Pin
11027	Clutch centrifugal unit	11061	Shock absorber gear
11028	Dowel	11062	Shock absorber plate
11029	Return spring	11063	Shock absorber rubber piece
11030	Lock washer	11064	Rubber piece plaque
11031	Clutch retaining nut	11065	Plate (locating rubber pieces)
11032	Pressure arms	11066	Securing circlip
11033	Bush		

### Illustration 3 - FRAME - SADDLE - FENDER - TELESCOPIC FORK

12000	Frame	12035	Stud (fixing engine)
12001	Rear fender (front section)	12036	Nut
12002	Rear fender (rear section)	12037	Washer
12003	Luggage-carrier (front section)	12038	Threaded fork stem cone and hubs
12004	Luggage-carrier (rear section)	12039	Fork stem cone (not threaded)
12005	Complete rear fender	12040	Cup
12006	Complete luggage-carrier	12041	Washer
12007	Screw	12042	Ball
12008	Mudflap	12043	Distance piece
12009	Bracket (fixing fender)	12044	Stem gudgeon
12010	Carrier supporting rod	12045	Nut
12011	Distance piece	12046	Washer
12012	Washer	12047	Front fork (complete)
12013	Screw	12048	Top lug
12014	Fuel tank	12049	Lower lug
12015	Fuel tank filler cap	12050	Fork bearing stanchion (with tie rod)
12016	Fuel cock	12051	Upper spring
12017	Strap (holding fuel tank)	12052	Lower spring
12018	Saddle unit (complete with support pillar and screw)	12053	Stanchion (bare)
12019	Saddle	12054	Tie rod
12020	Saddle supporting pillar	12055	Washer
12021	Stud (fixing saddle to pillar)	12056	Indented washer
12022	Nut	12057	Bush
12023	Bush	12058	Adaptor
12024	Screw (fixing saddle pillar to saddle tube)	12059	Adaptor (for rear fender)
12025	Nut	12060	Bracket
12026	Spring washer	12061	Front fender
12027	Screw	12062	Fender support
12028	Chain guard	12063	Muffler
12029	Stand (complete)	12064	Exhaust pipe
12030	Stand bar	12065	Gasket
12031	Rubber foot for stand	12066	Baffle plate
12032	Bracket	12067	Muffler cover
12033	Spring	12068	Fuel pipe
12034	Cap	12069	Nut
		12070	Bracket (fixing saddle)

### Illustration 4 - WHEELS - HUBS - HANDLEBAR - CABLES

13000	Wheel rim	13020	Screw (brake adjuster)
13001	Spoke with nipple	13021	Chain
13002	Tire	13022	Chain link
13003	Tube	13023	Handlebar (bare)
13004	Rim Bead	13024	Support (of handlebar)
13005	Hub (complete)	13025	Nut (fixing handlebar)
13006	Hub (bare)	13026	Throttle (without twistgrip)
13007	Distance piece	13027	Throttle bracket
13008	Chain stretcher	13028	Screw
13009	Sprocket wheel	13029	Dowel (fixing throttle to handlebar)
13010	Screw	13030	Twistgrip (R. H.)
13011	Brake disk	13031	Twistgrip (L. H.)
13012	Hub (front wheel)	13032	Twistgrip
13013	Hub (rear wheel)	13033	Support (holding front brake lever)
13014	Bracket	13034	Support (holding rear brake lever)
13015	Brake arm (inside)	13035	Lever (operating brake)
13016	Brake arm (outside)	13036	Screw (fixing lever)
13017	Brake lining	13037	Nut
13018	Spring	13038	Support (holding clutch lever)
13019	Nut (brake adjuster)	13039	Clutch operating lever

13040	Screw (fixing lever)	13049	Throttle cable (complete)
13041	Bush	13050	Cone-shaped cable stop
13042	Front brake cable (complete)	13051	Cable clamp bolt
13043	Rear brake cable (complete)	13052	Clutch adjuster (complete)
13044	Clutch cable (complete)	13053	Brake cable terminal
13045	Front brake cable (bare)	13054	Throttle adjusting screw
13046	Rear brake cable (bare)	13055	Spring
13047	Sheath (front brake cable)	13056	Sheath clamp.
13048	Sheath (rear brake cable)		

## Illustration 5 - LIGHTING - TOOLKIT

14000	Flywheel magneto	14026	Screw
14001	Flywheel rotor	14027	Spring (fixing parabolic reflector set)
14002	Stator plate (complete)	14028	Screw (fixing lamp rim)
14003	Stator plate (bare)	14029	Lighting switch (complete with cables)
14004	H. T. coil (with sparking plug cable)	14030	Set of cables
14005	Sparkling plug cable	14031	Cable (for lighting)
14006	Bush	14032	Tail lamp
14007	Lighting coil	14033	Reflector rim
14008	Condenser	14034	Shell
14009	Contact breaker	14035	Elongated bulb
14010	Set of washers (for contact breaker)	14036	Nut
14011	Set of washers and nut (to hold contact breaker)	14037	Screw (fixing lamp rim)
14012	Coil fixing screw	14038	Buzzer (complete)
41013	Washer	14039	Bracket
14014	Screw (fixing condenser)	14040	Gasket
14015	Screw (fixing contact breaker to stator plate)	14041	Screw
14016	Screw (fixing stator plate)	14042	Inflator (with connection)
14017	Sparkling plug cover	14043	Connection
14018	Sparkling plug	14044	Toolkit (complete with bag)
14019	Headlamp (with lighting switch)	14045	Plug box wrench
14020	Headlamp shell	14046	Spanner
14021	Parabolic reflector set	14047	Tire lever
14022	Lamp rim	14048	Screwdriver
14023	Lower beam lamp	14049	Cloth toolbag
14024	Side light lamp	14050	Toolkit box with lid
14025	Grommet	14051	Box lid
		14052	Rivet

## Illustration 6 - CARBURATOR

1104-37	Adjuster (throttle cable)	6107-96	Float chamber
1486-02	Jet	6108-64	Throttle valve
1691-27	Nut (cable adjuster)	6109-29	Fuel filter
2838-05	Needle	6110-53	Valve cover
3318-36	Screw (fixing valve cover)	6111-30	Gasket (for valve cover)
3346-61	Return spring	6112-26	Lever
3385-30	Gasket (for screw fixing fuel pipe)	6114-64	Valve
3598-36	Screw (fixing float chamber)	6115-22	Lever pin
3606-61	Spring (for adjusting screw)	6117-86	Filter
4190-36	Screw (fixing pipe)	6122-80	Float
4226-85	F.27 muffler cowling	6123-30	Gasket (for float chamber)
4560-22	Float pin	6140-37	Adjusting screw (for slow running)
4611-50	Ring (holding cowling)	6159-30	Gasket (for filter)
4617-36	Screw (fixing ring)	6259-61	Valve return spring
4879-35	Air inlet pipe	6304-27	Link (for screw fixing sleeve)
5417-22	Valve pin	6305-36	Screw (fixing sleeve)
6105-61	Valve return spring	6448-62	Insulating piece
6106-38	Pipe (fuel feed)	1502	Carburator (complete with throttle)



**LAVERDA**

---